

148.00 mm



QUICKSTEP

Bagless Stick Vac

USER GUIDE



DSV-VC-HKA

148.00 mm

LET'S GO.



清理及清洗過濾網

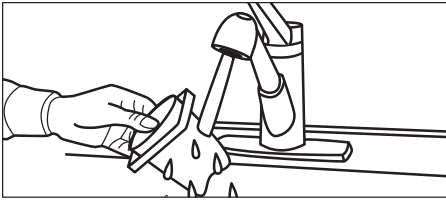

用自來水沖洗過濾網。切勿使用肥皂/洗滌劑。輕拍過濾網以除去多餘水漬。過濾網須乾透最少24小時方可重新放入集塵筒內。

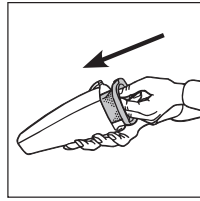

將過濾網輕輕推入集塵筒內。

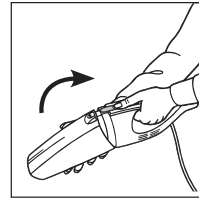

重新裝入集塵筒：將集塵筒底部對準後放入直至緊扣位置。

故障檢修指南

警告：降低受傷的風險——拔掉吸塵機電源方可維修

吸塵工具無法吸塵

- 縫隙吸頭堵塞。請移除縫隙工具；清除異物。
- 集塵筒已滿。請清空集塵筒。
- 過濾網堵塞。請清洗過濾網。

吸塵機沒有吸力或吸力不佳

- 集塵筒安裝不正確。請查閱「集塵筒與過濾網的拆卸和更換」。
- 集塵筒已滿。請清空集塵筒。
- 過濾網堵塞。請拆下並清洗過濾網。
- 吸塵入口管堵塞。請卸下吸頭；清除障礙物。

塵屑從吸塵機溢出

- 集塵筒已滿。請清空集塵筒。
- 集塵筒安裝不正確。請查閱「集塵筒與過濾網的拆卸和更換」。
- 過濾網安裝不正確。請查閱「集塵筒與過濾網的拆卸和更換」。
- 過濾網充滿污垢。請清洗或更換過濾網。

吸塵機無法運作

- 電源線可能未牢固地插入插座。請將插頭牢固插入插座。

IMPORTANT SAFETY INSTRUCTIONS

THIS VACUUM IS INTENDED FOR HOUSEHOLD USE ONLY.

When using an electrical appliance, basic precautions should always be followed, including the following:

- **READ ALL INSTRUCTIONS BEFORE USING THIS APPLIANCE.**
- **ALWAYS FOLLOW THESE SAFETY INSTRUCTIONS.**
- **DO NOT LEAVE CLEANER UNATTENDED.**

WARNING: TO REDUCE THE RISK OF FIRE, ELECTRIC SHOCK OR INJURY:

- Fully assemble before operating.
- Operate cleaner only at voltage specified on data plate on back of cleaner.
- Do not use outdoors or on wet surfaces.
- Do not allow to be used as a toy. Not intended for use by children age 12 and under. Close supervision is necessary when used near children. To avoid injury or damage, keep children away from product, and do not allow children to place fingers or other objects into any openings.
- Use only as described in this manual. Use only manufacturer's recommended attachments.
- Do not use with damaged cord or plug.
- Do not pull or carry by cord, use cord as a handle, close a door on cord, or pull cord around sharp edges or corners. Do not run vacuum cleaner over cord. Keep cord away from heated surfaces.
- Do not unplug by pulling on cord. To unplug, grasp the plug, not the cord.
- Do not handle plug or appliance with wet hands.
- Do not put any object into openings. Do not use with any opening blocked; keep free of dust, lint, hair and anything that may reduce air flow.
- Keep hair, loose clothing, fingers, and all parts of body away from openings and moving parts.
- Turn off all controls before unplugging.
- Use extra care when cleaning on stairs. To avoid personal injury or damage, and to prevent the cleaner from falling, always place cleaner at bottom of stairs or on floor. Do not place cleaner on stairs or furniture, as it may result in injury or damage.
- Do not use to pick up flammable or combustible liquids, such as gasoline, or fine wood sandings or use in areas where they may be present.
- Do not pick up anything that is burning or smoking, such as cigarettes, matches or hot ashes.
- Store the product indoors. Put the product away after use to prevent tripping accidents.
- Do not use without filters and/or dirt cup in place.
- Any other servicing should be done by an authorized service representative.
- Do not leave appliance when plugged in. Unplug from outlet when not in use and before servicing.

CAUTION: TO REDUCE THE RISK OF DAMAGE:

- Avoid picking up hard, sharp objects with this product, as they may cause damage.

SAVE THESE INSTRUCTIONS

WARNING:

This plug will fit in a polarized outlet only one way. If the plug does not fit fully in the outlet, reverse the plug. If it still does not fit, contact a qualified electrician to install the proper outlet. Do not change the plug in any way.





CLEANER DESCRIPTION

1. Handle Grip
2. Upper Cord Wrap (located on back of handle grip)
3. Handle Tube
4. Handle Release Button
5. Lower Cord Wrap (located on back of hand vac)
6. On/Off Switch
7. Dirt Cup Release Button
8. Power Cord
9. Dirt Cup
10. Dirt Inlet Tube
11. Floor Nozzle
12. Wheels
13. Quickstep Crevice Tool*
14. Tool Clip*
15. Crevice Tool*

Depending on model Crevice Tool can be on Hand vac or on Tool clip* attached to handle.

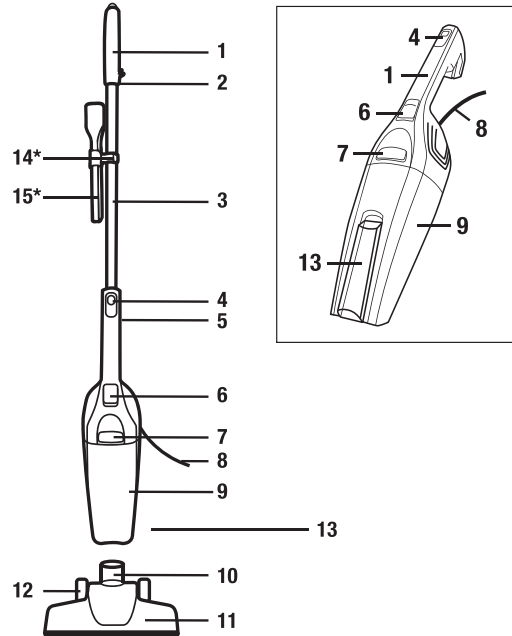

手提吸塵機附件

縫隙吸頭的操作及存放

縫隙吸頭永久地存於板上。它位於集塵筒之上，以便使用。

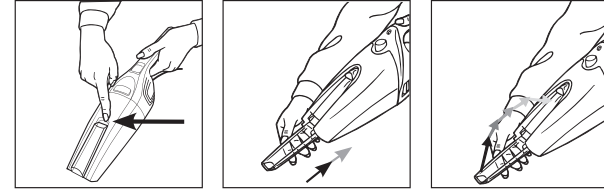

1. 鬆開縫隙吸頭。
2. 將縫隙吸頭向下翻開直至與吸塵機吸頭同一直線後往上推至牢固位置。
3. 存放縫隙吸頭：往下拉至鬆開位置。將縫隙吸頭向上翻直至鎖定到位。

集塵筒與過濾網：拆卸和更換

重要事項：每次使用後，清潔過濾網以獲得最佳效果。

注意：為確保最佳性能，請每隔6個月更換過濾網。

清倒及清洗集塵筒

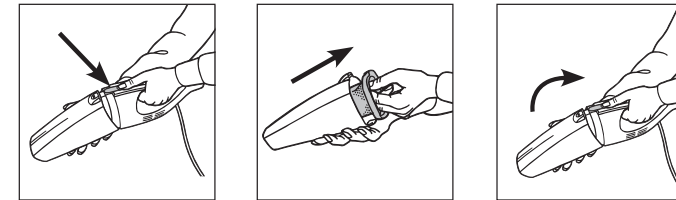

往下按集塵筒分離掣並從吸塵機拿開噴嘴。

將集塵筒放在廢紙簍上方。抓緊過濾網及輕輕拉出。

搖抖集塵筒抖出灰塵及垃圾。將塵埃及灰塵從過濾網刷掃出來，或在廢紙簍內搖抖過濾網。





如何進行直立式操作

開機：將電源開關撥到ON位置。
關機：將電源開關置於OFF位置。

- 每次使用或吸入大量塵垢後，請清空并清洗本機及過濾網。

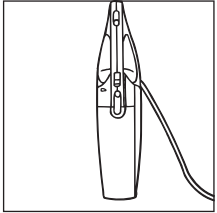

將吸塵機置於直立狀態。

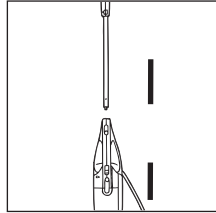

向下滑動手柄直至扣緊。

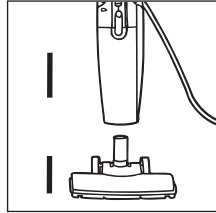

將地板工具插入集塵筒吸頭。用力按下以確保連接正確。

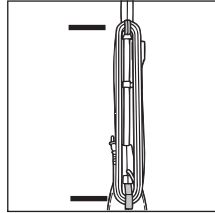

存放時，將電線纏繞在吸塵機背面的掛鉤上。

如何以手提方式操作

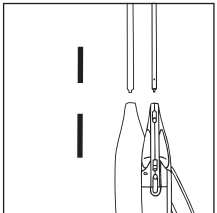

將吸塵機置於直立狀態，吸塵機後端向上。向前推分離掣，將手柄從吸塵機拉出。

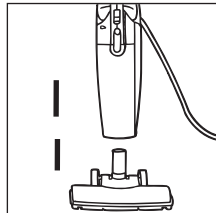

將地板工具從吸塵機吸頭上移除。

開機：將電源開關撥到ON位置。
關機：將電源開關置於OFF位置。

- 每次使用或吸入大量塵垢後，請清空并清洗本機及過濾網。



HOW TO USE AS A STICK VAC

TO USE: Slide the power switch to the ON position.

TO TURN UNIT OFF: Slide the power switch to the OFF position.

- Empty and clean the unit and filter after each use or after large pickups when the unit becomes full.

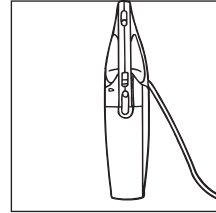

Hold body of unit in an upright position.

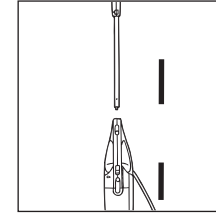

Slide handle down until it snaps in place.

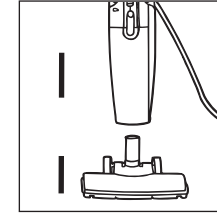

Insert floor tool into dirt cup nozzle. Firmly press to assure proper connection.

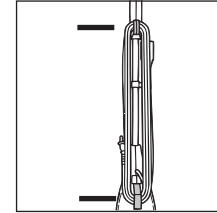

For storage, wrap cord around hooks located on back of cleaner.

HOW TO USE AS A HAND VAC

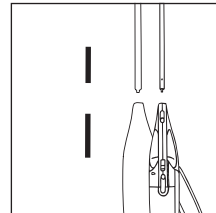

Place unit in an upright position with the back of the unit facing forward. Push release button forward, then pull handle from unit.

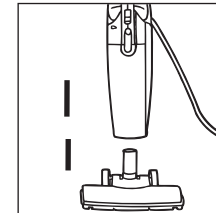

Remove the floor tool from the nozzle.

TO USE: Slide the power switch to the ON position.
TO TURN UNIT OFF: Slide the power switch to the OFF position.

- Empty and clean the unit and filter after each use or after large pickups when the unit becomes full.



HAND VAC ATTACHMENTS

USING AND STORING THE CREVICE TOOL

The crevice tool is permanently stored on-board. It is located on the top of the dust cup for your convenience.

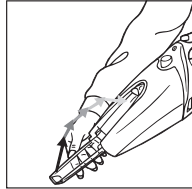
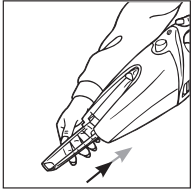
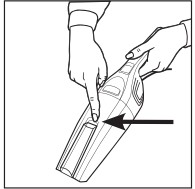

1. Unsnap the crevice tool.
2. Flip crevice tool down to line up with nozzle then press up until secure in place.
3. To store crevice tool: Pull down until loose. Flip crevice tool up towards unit and you feel it lock into place.

DIRT CUP & FILTER: REMOVAL & REPLACEMENT

IMPORTANT: FOR BEST RESULTS, CLEAN THE FILTER AFTER EACH USE.

NOTE: For best performance, replace filter every 6 months.

EMPTY & CLEAN DIRT CUP

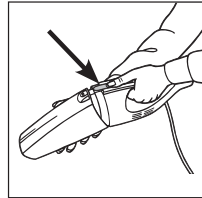

Depress the dirt cup release button and pivot nozzle away from unit.

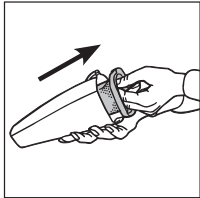

Hold dirt cup over a wastebasket. Grasp filter and gently pull out.

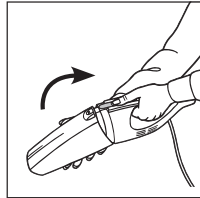

Shake excess dirt and debris out of dirt cup. Brush the dust and dirt off the filter, or shake the filter inside of the wastebasket.

吸塵機產品說明

1. 手把握柄
2. 上方電線捆控位 (位於手把握柄後面)
3. 手柄長管
4. 手柄分離掣
5. 下方電線捆控位 (位於手提式吸塵機後面)
6. 開/關按鈕
7. 集塵筒分離掣
8. 電源線
9. 集塵筒
10. 地板吸頭接駁口
11. 地板吸頭
12. 輪子
13. Quickstep縫隙吸頭*
14. 縫隙吸頭緊定夾*
15. 縫隙吸頭*

*取決於不同的型號，縫隙吸頭*可以安裝在手提式吸塵機上，也可安裝在手柄上安裝的縫隙吸頭緊定夾*上。

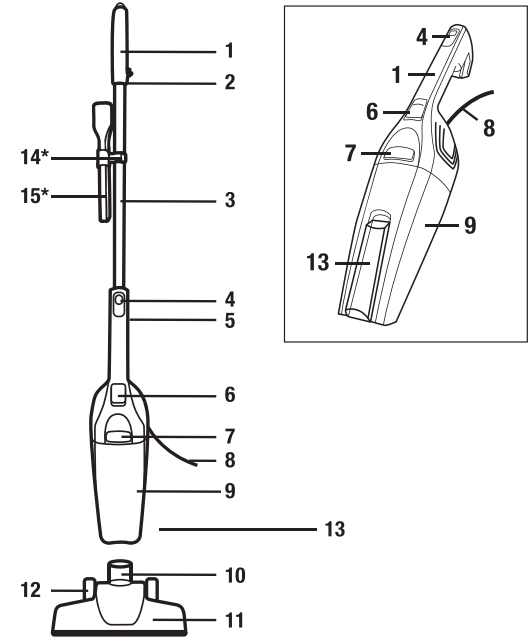



重要安全指引

- 本機僅為家居使用。
使用電器時，務必遵守基本注意事項，包括下列幾點：
- 使用本產品前，請先詳讀所有的指示。
 - 遵循以下安全指示。
 - 請看管好你的吸塵機

警告：為降低引起火災、電擊或受傷的風險：

- 組裝完成後才可操作。
- 請按背面指定的電壓下操作本機。
- 不要在室外或潮濕的表面上使用。
- 不可將本產品當做玩具使用。12歲或以下的兒童不宜使用。使用時若附近有兒童，請務必嚴密監控使用。為避免受傷或產品損壞，請讓兒童遠離本產品，勿讓兒童將手指及其他異物放入吸塵機的吸頭中。
- 請務必遵照本手冊說明使用及使用製造商的附件。
- 不得使用損壞的電線或插頭。
- 請勿拉扯電線或用電線提起吸塵機、將電線當做把手使用、令電線受門縫擠壓，或沿著尖銳邊緣或角落拉扯電線。使用本產品時請勿壓住電線。電線不可接觸發熱的表面。
- 拔出插頭時請勿拉扯電線。拔出插頭時請抓住插頭，請勿拉扯電線。
- 手部沾濕時，請勿接觸插頭或使用本產品。
- 請勿將任何異物放入拖洗吸塵機的吸頭中。當吸頭有任何堵塞時請勿使用；請保持產品不受灰塵、棉屑、毛髮以及任何物品所堵塞。
- 請注意避免毛髮、寬鬆的衣服、手指和身體的任何一部份接近吸頭。
- 請先關閉所有電源，再拔出插頭。
- 清潔樓梯時需特別小心。為避免造成受傷或產品損壞，並避免吸塵機掉落，請將吸塵機放置在地板上。請不要將吸塵機放在樓梯級或傢俱上，因為可能會造成受傷或損壞。
- 請勿用產品吸易燃或可燃液體例如汽油，或在可能有這些液體的地方使用本產品。
- 請勿用本產品吸起任何正在燃燒或冒煙的物體，如香煙、火柴或滾燙的灰燼。
- 本產品須存儲於室內。使用本產品後請收好產品，以防絆倒。
- 請勿在未安裝過濾網和/或集塵筒時使用。
- 任何其他保養應由授權服務中心人員進行。
- 在無人看管的情況下，不要將吸塵機接通電源。不使用時緊記要從插座拔出電源。

小心：為降低損壞的風險：

- 請避免使用本產品吸堅硬、尖銳的物體，以免損壞。

請保留此手冊以供日後參考

警告：

此插頭只有一個方向可配對插座。如果插頭不能完全插進插座，請把插頭倒轉再試。如果仍然不能完全配對，請聯絡合資格電器技工，以安裝適當的插座。在任何情況下都不可替換插頭。



CLEAN & RINSE FILTER

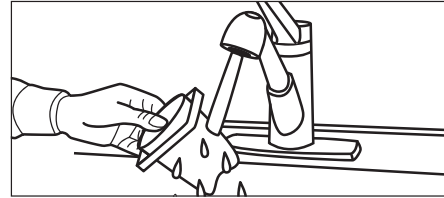

Hold filter under running water to rinse. DO NOT use soap/detergent. Tap excess water out of filter. Allow filter to COMPLETELY DRY for at least 24 hours before replacing in dirt cup.

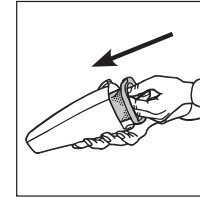

Gently push filter back into dirt cup.

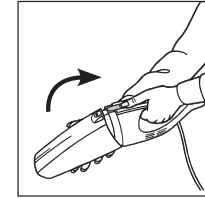

To reattach dirt cup: Align bottom first and pivot dirt cup until it snaps into place.

TROUBLESHOOTING GUIDE

Cleaner tools won't pick up

- Crevice tool clogged. Remove crevice tool; remove obstruction.
- Dirt cup is full. Empty dirt cup.
- Filter clogged. Clean filter.

Cleaner won't pick up or low suction

- Dirt Cup not installed correctly. Review Dirt Cup and Filter Removal and Replacement.
- Dirt cup is full. Empty dirt cup.
- Clogged filter. Remove filter and clean.
- Dirt inlet tube clogged. Remove nozzle; remove obstruction.

WARNING: TO REDUCE RISK OF PERSONAL INJURY – UNPLUG CLEANER BEFORE SERVICING

Dust escaping from cleaner

- Dirt cup is full. Empty dirt cup.
- Dirt Cup not installed correctly. Review Dirt Cup & Filter Removal & Replacement.
- Filter not installed correctly. Review Dirt Cup & Filter Removal & Replacement.
- Filter is dirty. Clean filter or replace.

Cleaner won't run

- Power cord not firmly plugged into outlet. Plug unit in firmly.



使用手冊

QUICKSTEP

無塵袋直立式真空吸塵機



DSV-VC-HKA

入門指南